

3030(35)s6,

3030(44)s6

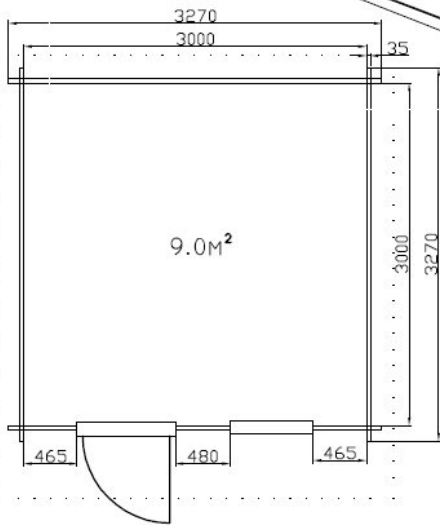
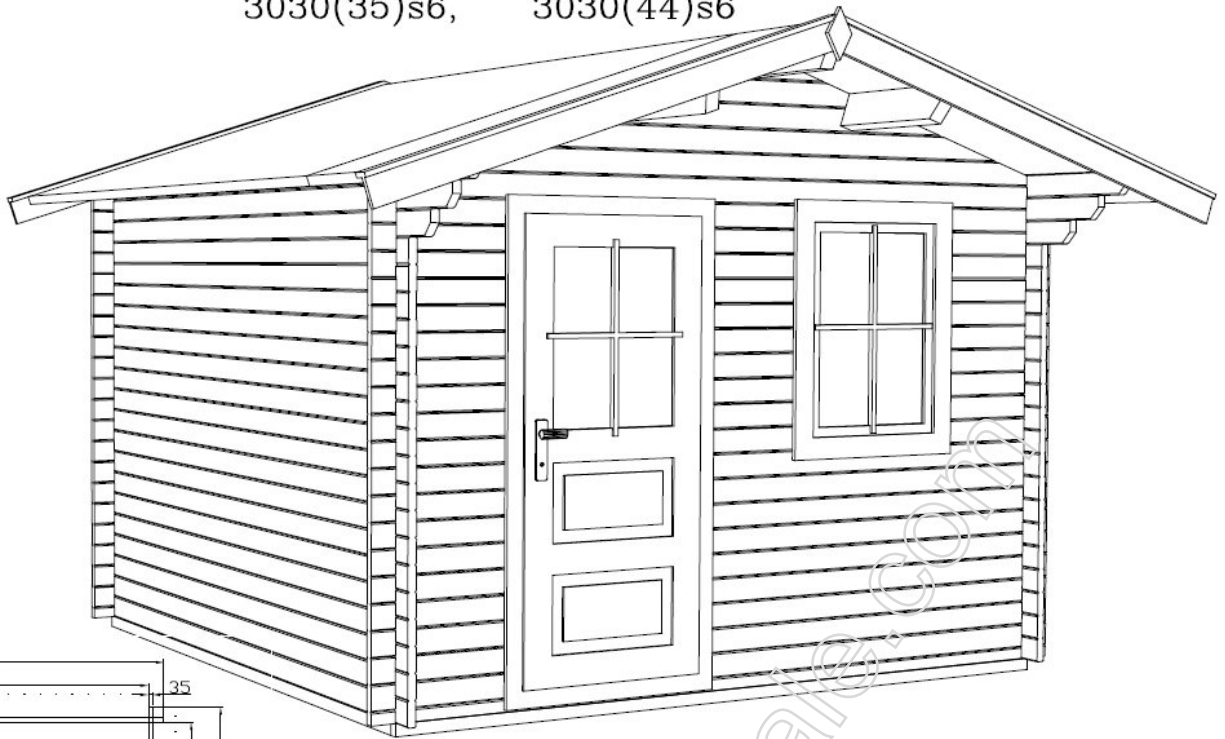

Garden house 3,00*3,00m(9m²) + roof 0,60m . Wall thickness 35, 44mm with double plank profile from pine or fir wood. All wooden constructions are dried until 10–12%, without painting and impregnation. Door with glass and lock, windows with glass with simple opening system.

Other technical data:

- floor planks 22mm
- underground 100*40, 50*40mm
- roof planks 19mm
- rafter 140*44mm

Wall height: 2,10m

House height: 2.61m

Other modifications:

3030(35)Ls10 3030(35)Ls15
3030(44)Ls10 3030(44)Ls15

3040(35)Ls10 3040(35)Ls15
3040(44)Ls10 3040(44)Ls15

3040(44)s10Extra5

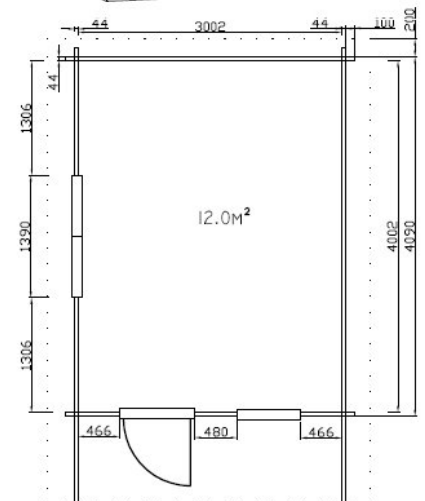
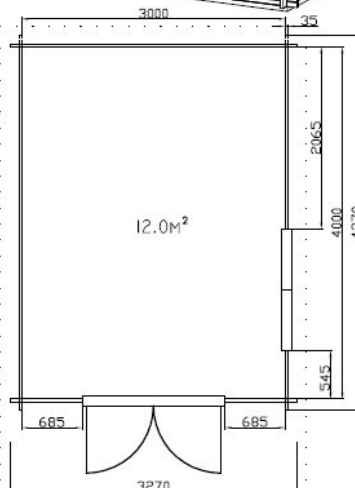
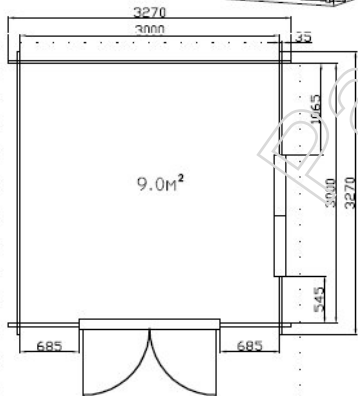
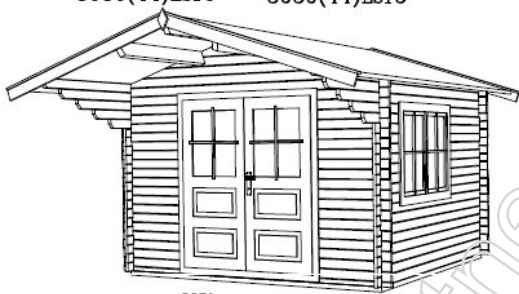

Garden house 3,00*3,00m (9m²) + roof 1.00m(1,50m), double door.

All houses wall height: 2,10m
All houses height: 2.61m

Garden house 3,00*4,00m (12m²)+ roof 1.00m(1,50m), double door.

Garden house 3,00*4,00m (12m²) + roof 1.00m, single door.